

H Crimps



Compression tap connectors H-shape Cu

For copper cables as per DIN 48201-1.
For cable branchings and earth ring grid circuits.

Material, surface:
Cu uncoated or tin-plated

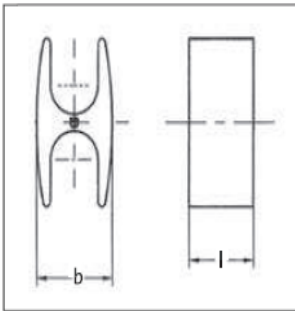

Item no. uncoated	Item no. tin-plated	Cross-section Main conductor	Cross-section Branch	Main conductor	Branch	Die code (mm)	Dimensions (mm)		Number of compressions	
		(mm ²)	(mm ²)	ø (mm)	ø (mm)		w	l	mech.	hydr.
301 335 335	301 335 001	6-10	6-10	2.8-4.1	2.8-4.1	10 PO	8	14	2	-
301 335 336	301 335 002	16	6-10	4.5-5.1	2.8-4.1	16 PO	10	18	2	-
302 364 364	302 364 001	16	10-16	4.5-5.1	3.5-5.1	16 PO	10	18	2	-
301 335 338	301 335 003	25	6-10	6.3	2.8-4.1	18 PO	12	18	2	-
301 335 340	301 335 004	25	25	6.3	6.3	18 PO	12	23	3	-
301 335 342	301 335 005	35	25	7.5	6.3	21 PO	15	25	3	-
301 335 343	302 435 154	35	35	7.5	7.5	21 PO	15	25	3	-
301 335 344	302 435 727	50	50	9.0	9.0	22 R	15	28	3	1
301 335 345	302 435 538	70	70	10.5	10.5	26 R	17	28	3	1
301 335 346	302 435 411	95	95	12.5	12.5	30 R	22	30	-	1
301 335 347	302 435 728	120	120	14.0	14.0	32 R	24	25	-	1
301 335 348	302 435 357	150	150	15.8	15.8	34 R	27	33	-	1

Sector-shaped conductors must be rounded with round-forming dies.